

Start in 4 steps with innovative ATEM switching

1. Load TouchDirector (Mini) App for iPad from the Apple AppStore
2. Connect your ATEM switcher (your HyperDecks optional) as well your iOS device to your Wi-Fi / Ethernet network.
3. Start TouchDirector (Mini) and adjust the ATEM (Mini)/ HyperDeck settings, the ATEM (Mini) panel buttons and your Key-Assignments
4. and Ready! Start innovative controlling of your ATEM Mini switcher!

Load TouchDirector (Mini) App from the Apple Appstore

TouchDirector (Mini) App for all ATEM Mini
TouchDirector Full for all ATEM

1-BUY

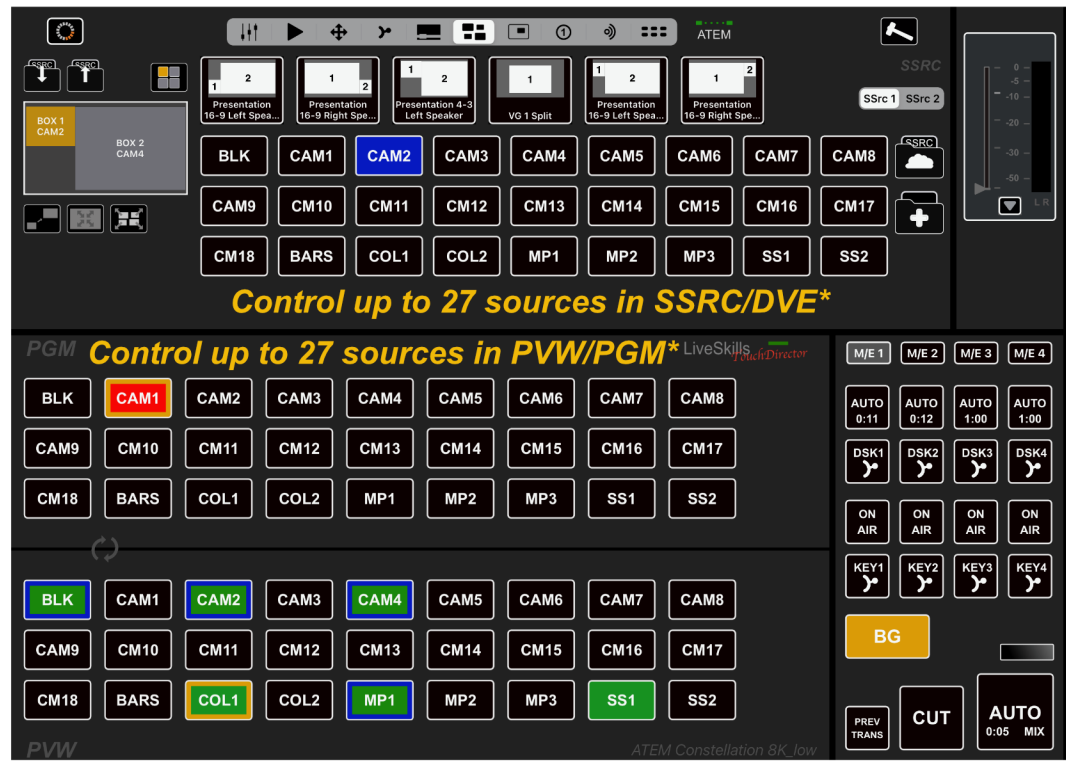

"Control up to 27 sources in PVW/PGM with iPad 12.9"

2-CONNECT

Connect your ATEM (Mini) switcher (your HyperDecks optional) as well your iOS device to your Wi-Fi / Ethernet network.

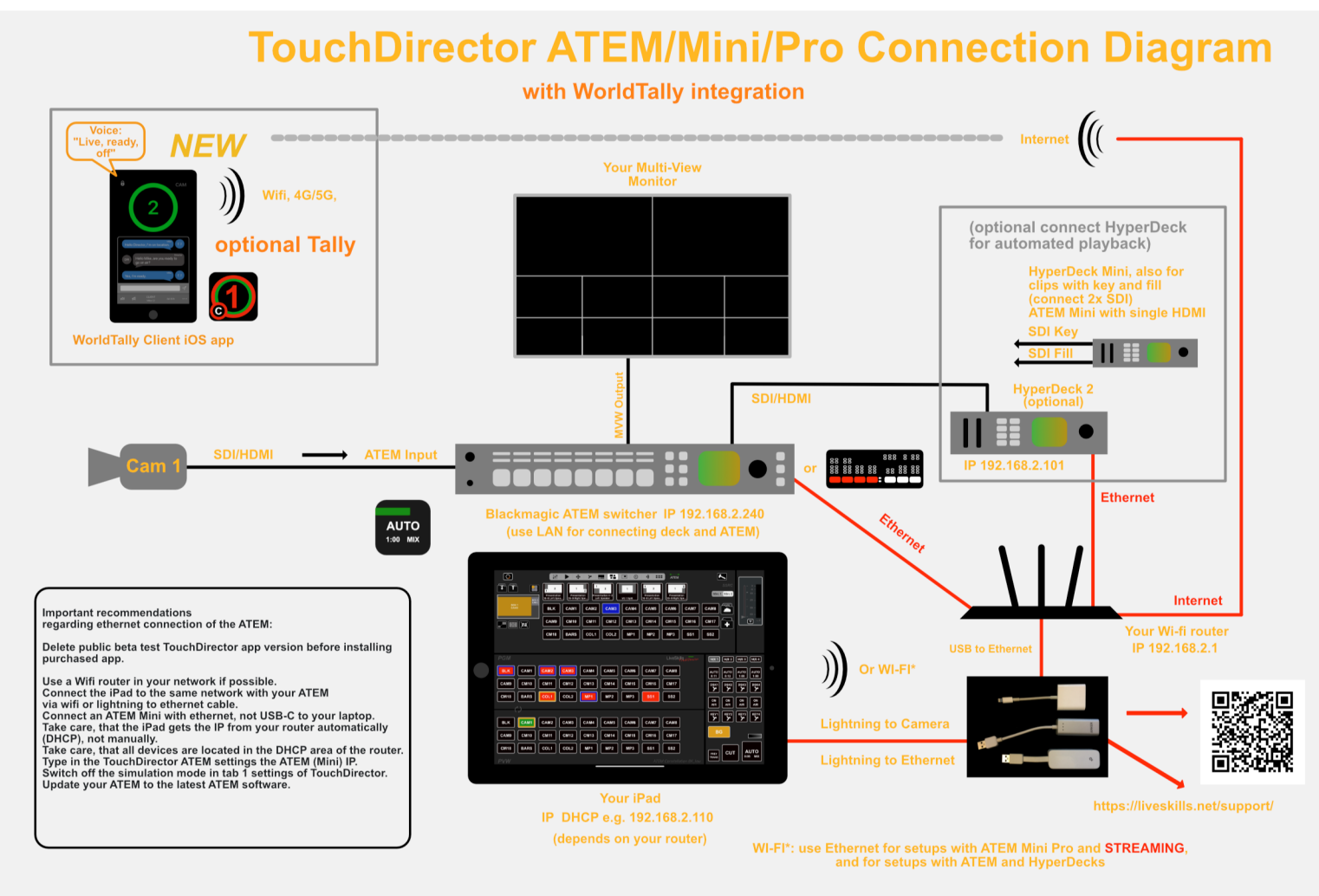

3-SET

adjust the ATEM (Mini) generally settings

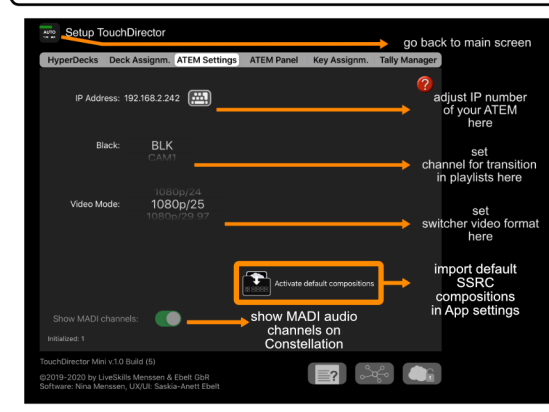

adjust the ATEM (Mini) panel settings

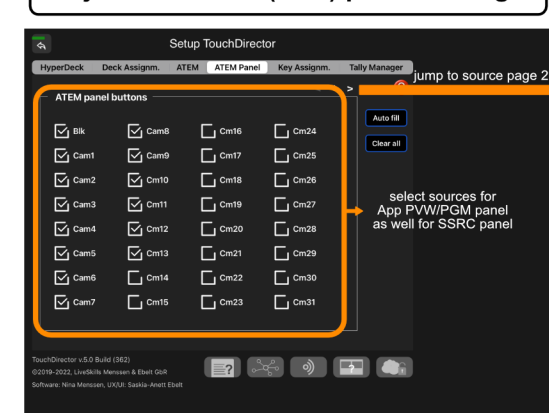

set the ATEM (Mini) key assignments

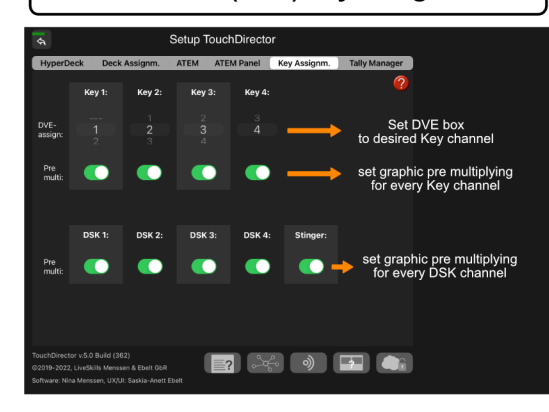

create and manage Tally session

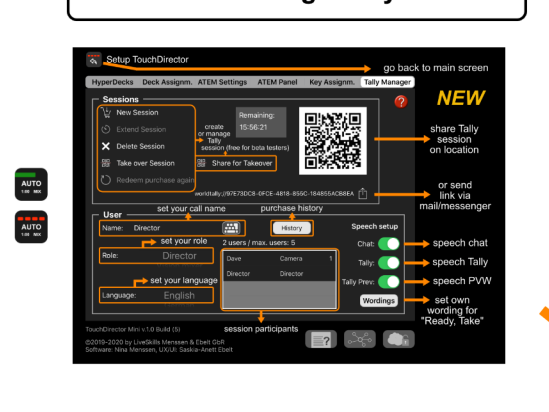

adjust the optional HyperDeck settings

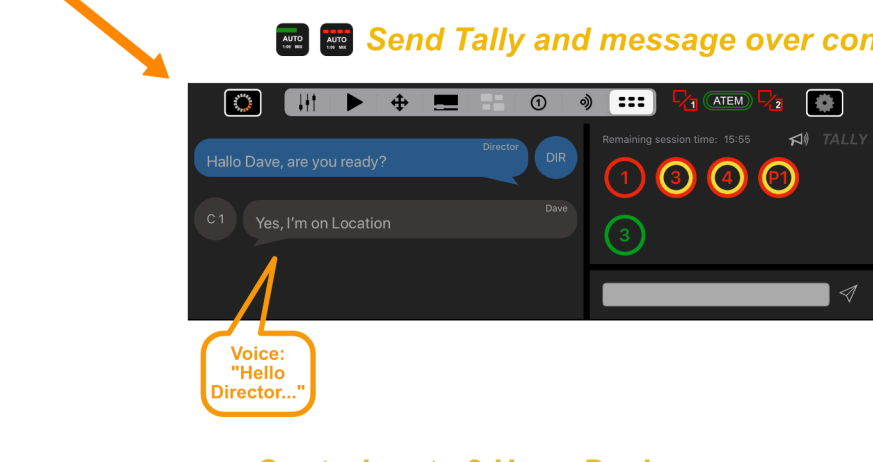
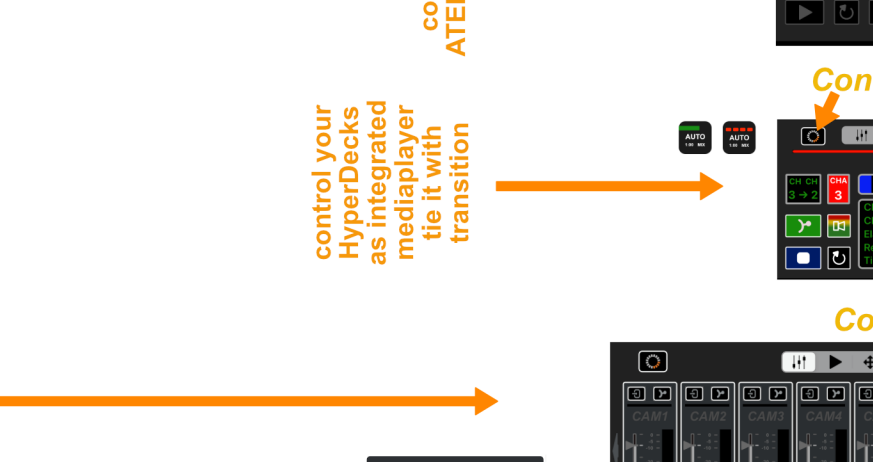
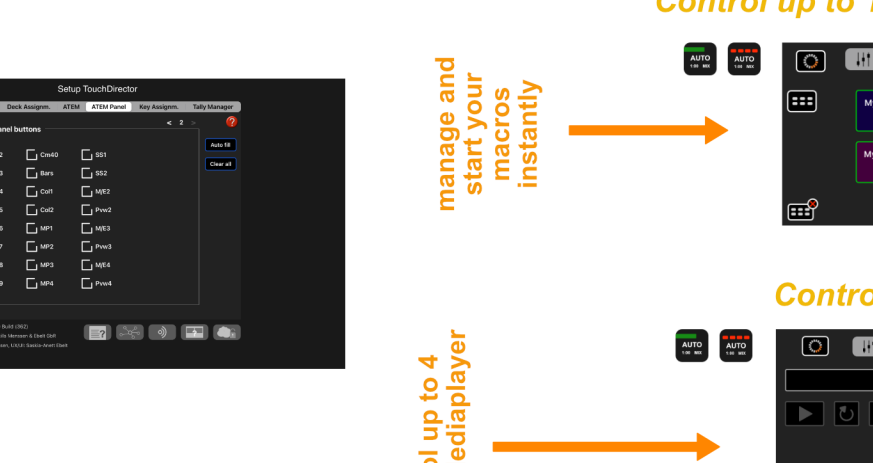
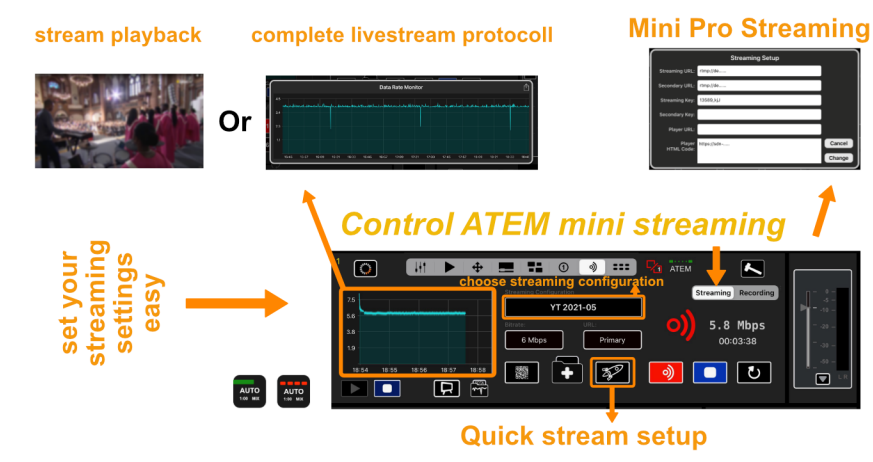
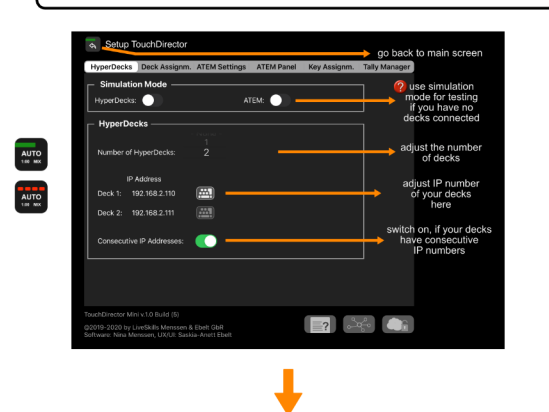

4-USE

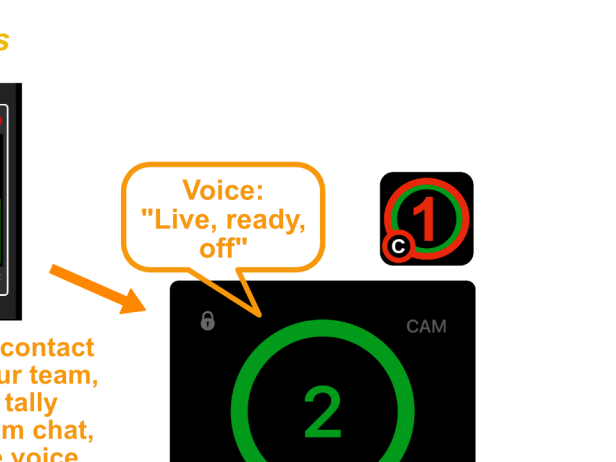
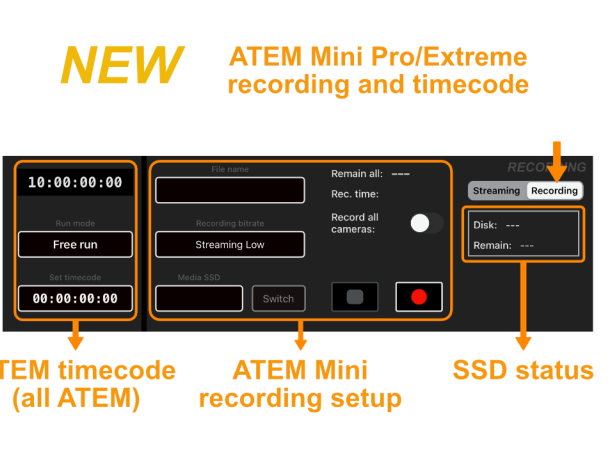

NEW in TD 5

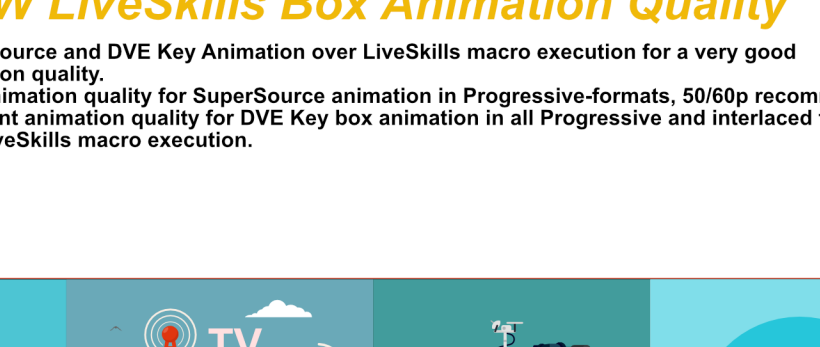
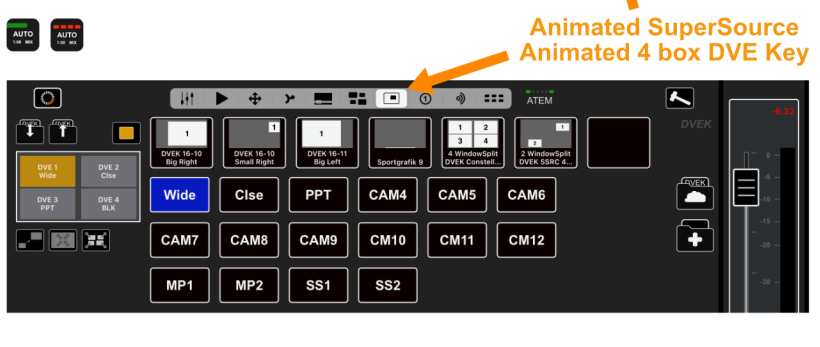
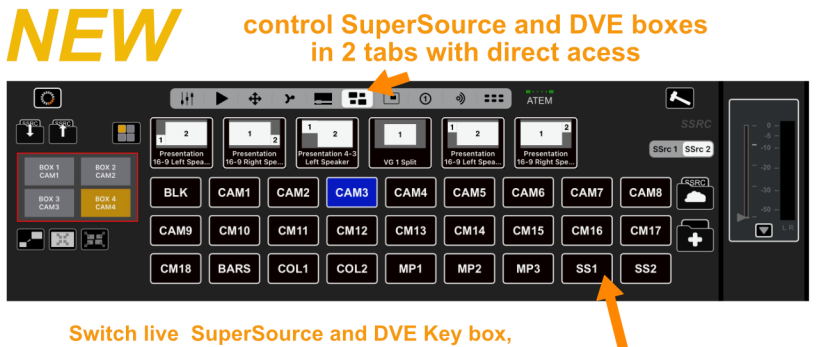
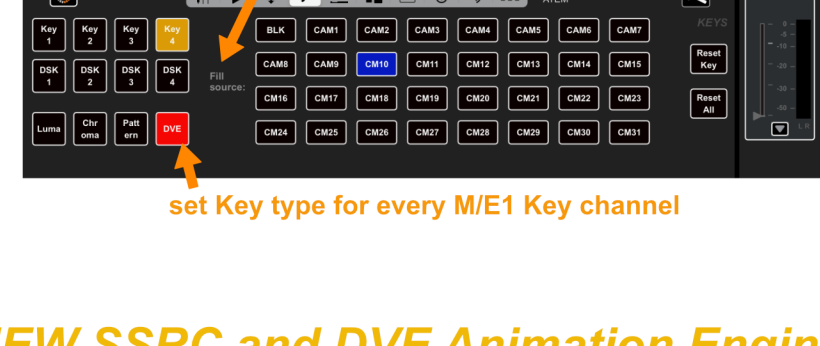
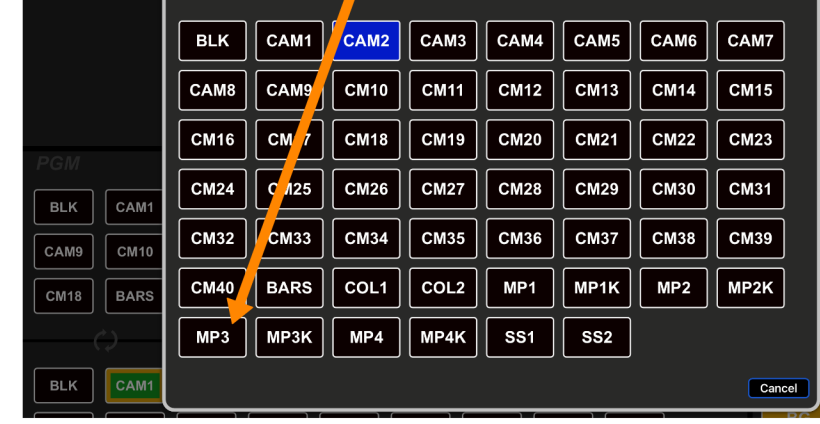
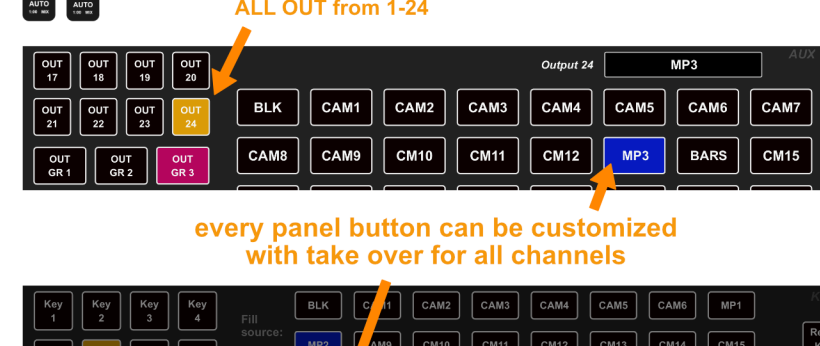
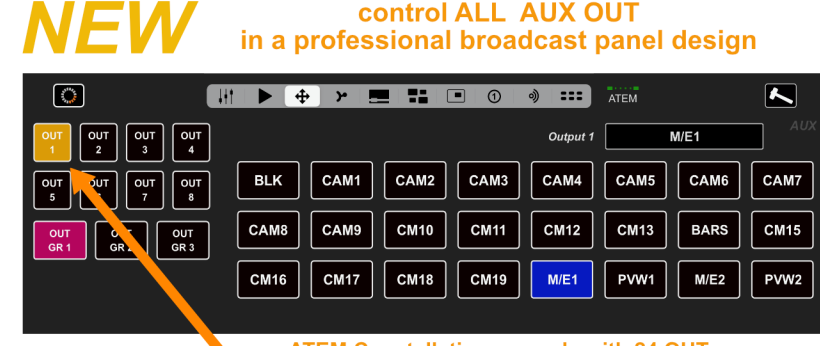

Macro Control
Media Player
HyperMedia Player

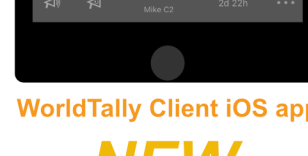
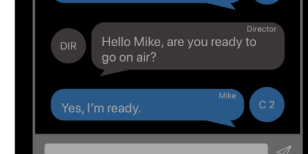
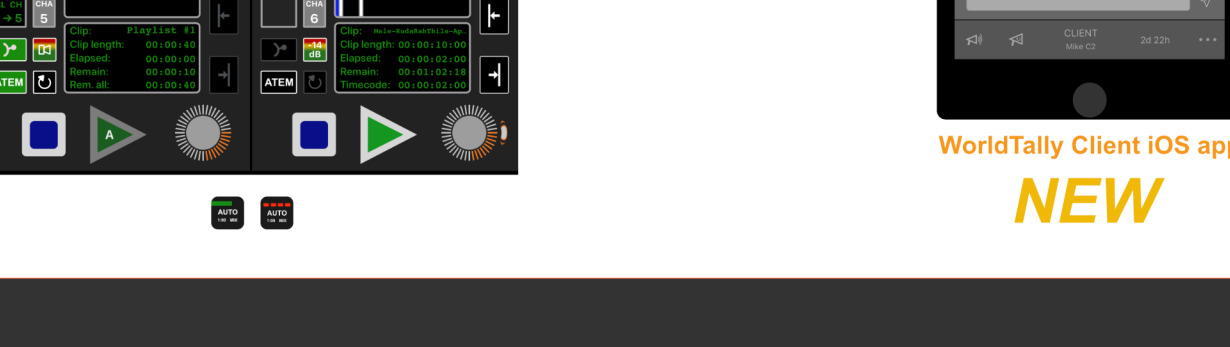
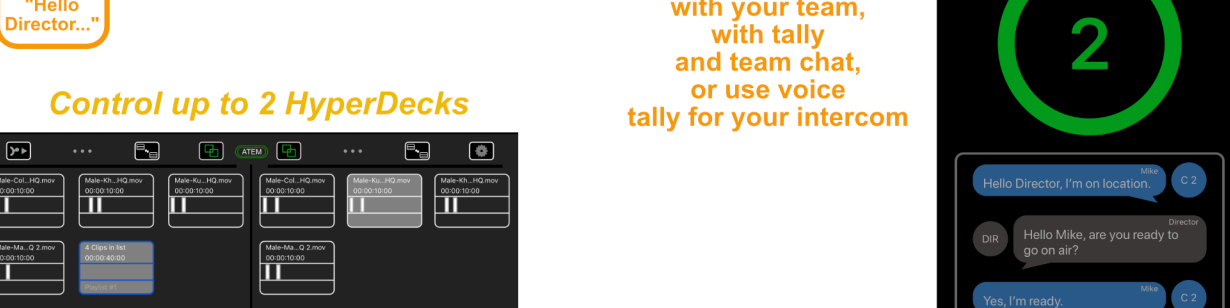
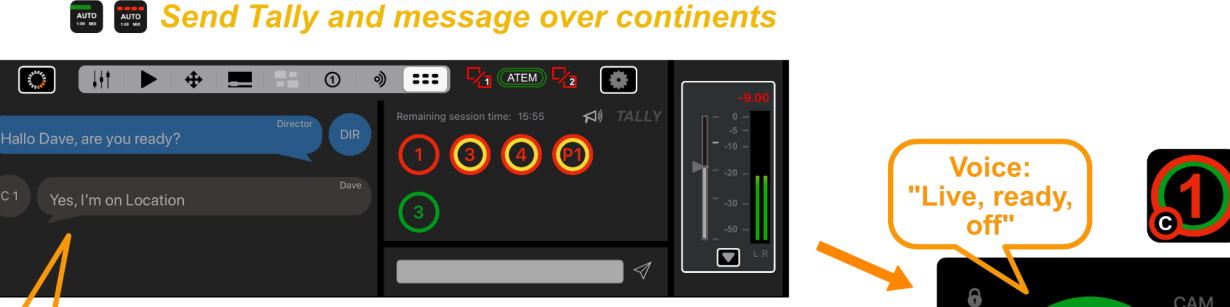

stay in contact with your team, with tally and team chat, or use voice tally for your intercom

see the clips on your HyperDecks play it single or repeat, automated with transition, and generate playlists